

# AMENITIES

- Washer and Dryer in Every Home
- Spacious Units
- Emergency Pull Cords
- Electric, Water/Sewer, Basic Phone and Cable Included
- Carports Available
- Regularly Scheduled Housekeeping
- 3 Professionally Cooked Meals Daily
- On-Site Beauty Salon
- Small Pets Welcome
- TV Room
- Wellness Room
- Activity Room
- Interior Mail Center
- Transportation for Local Healthcare Visits and Other Scheduled Outings Weekly
- Daily and Weekly Activities
- Online Rent Payment
- Library



## "Relax, You're Home Now"

Family-owned and operated, providing more than just housing. We bring out the highest degree of service to our buildings and residents while cultivating a community across the U.S. where our employees and partners can thrive through unique, quality acquisitions - achieving our goal; to make you feel right at home.

[www.npmainc.com](http://www.npmainc.com)



*"A Life Well Earned"*

## SILVER ELM ESTATES OF NORMAN

Call or text

**Phone: (405) 515-8300**

2100 36th Ave NW  
Norman, OK 73072

Email:

[silverelmnorman@npmainfo.com](mailto:silverelmnorman@npmainfo.com)



National Property Management  
Associates Inc. & Affiliated Companies

EST. 1965

"Relax, You're Home Now"



Silver Elm Estates of Norman is a charming community with 1 and 2 bedroom floor plans available. We offer weekly light housekeeping, three restaurant-style meals per day, beauty salon services, a wellness room, an activity room and much more. Each apartment home includes a refrigerator, stove and sink, washer and dryer, a walk-in shower and 2" blinds. We have daily and weekly resident activities, special guests and local transportation available for doctor's appointments and errands. We are close to shopping, restaurants and the highway is easily accessible. We look forward to providing the convenience in your life you have earned.

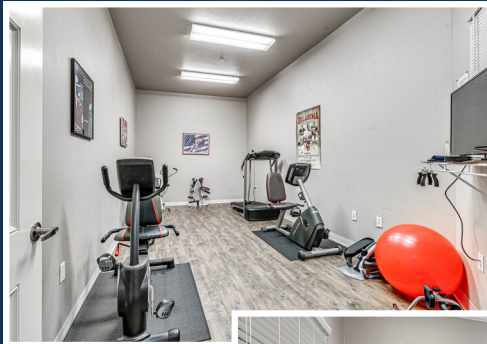

APPLY TODAY!



# FLOOR PLANS



**One Bedroom/One Bath  
(725 Square Feet)**

Rent: \_\_\_\_\_

Application: \_\_\_\_\_

Community Fee: \_\_\_\_\_

**Two Bedroom/One & 1/2 Bath  
(1070 Square Feet)**

Rent: \_\_\_\_\_

Application: \_\_\_\_\_

Community Fee: \_\_\_\_\_

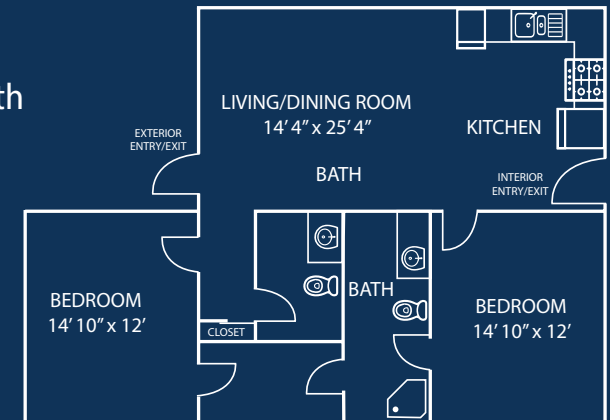

**Two Bedroom/Two Bath  
(1090 Square Feet)**

Rent: \_\_\_\_\_

Application: \_\_\_\_\_

Community Fee: \_\_\_\_\_